



UnifiM.I.TM

CONSTRUCTION, LLC

AN INTERFACE TECHNOLOGY COMPANY

INDUSTRY BREAKDOWN FOR FASTENERS

GLOBAL FASTENER SEGMENTS - \$85B

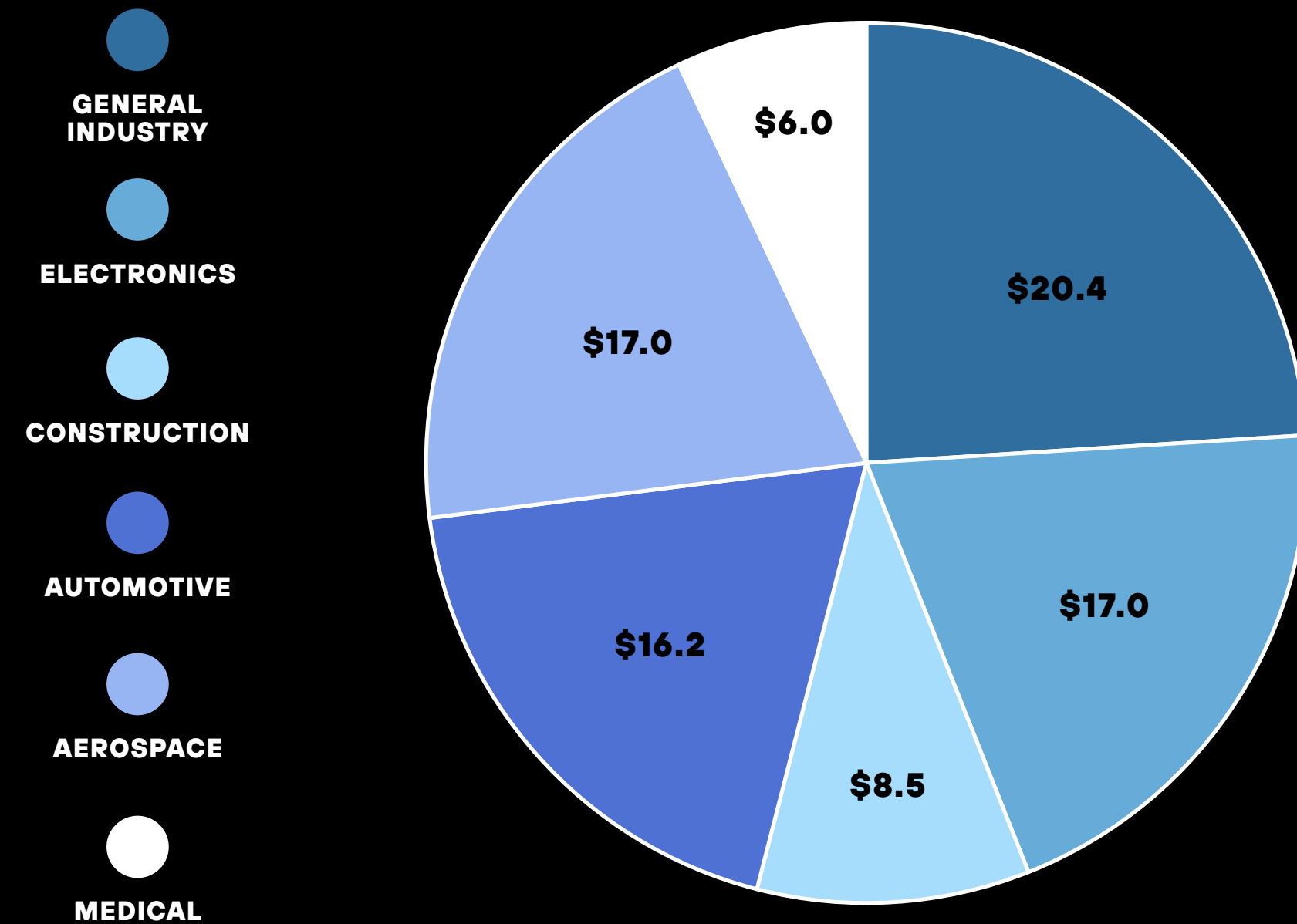

2024 REVENUE (\$B)

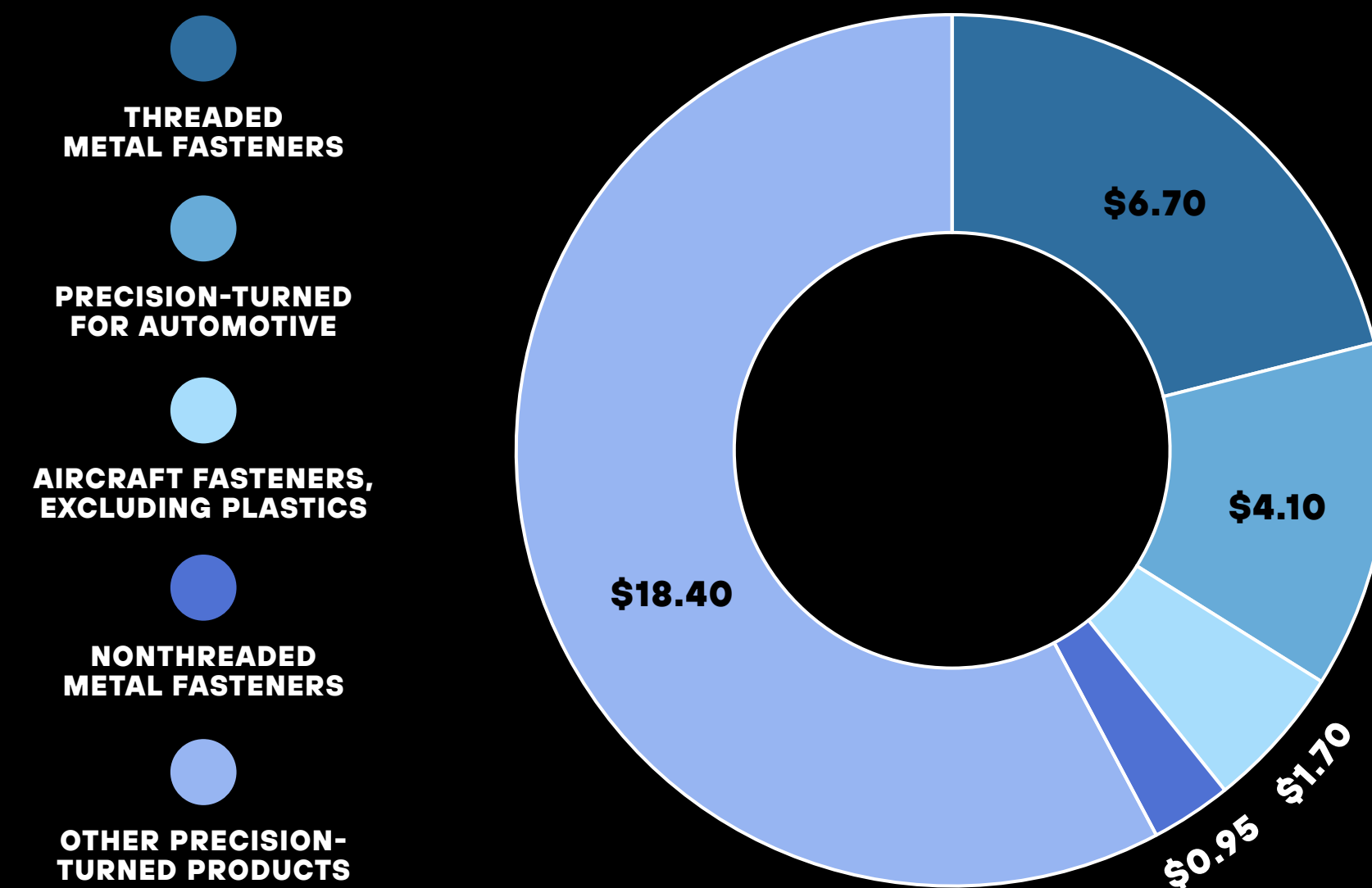

IBISWorld | Screw, Nut & Bolt Manufacturing in the US | May 2024
StanleyBlack&Decker| Investor Presentation| August 2024





EXPERIENCE MATTERS

UNIFIM.I. FASTENER TECHNOLOGY
TRANSFORMED THE MEDICAL
DEVICE INDUSTRY.

UTILIZED DAILY BY EXPERT SURGEONS
100 UNIVERSITY HOSPITALS TO
MAINTAIN IMPLANT STABILITY.

UNIFIM.I. PERFORMANCE CAPABILITIES

- ✓ PRESERVE THE SUBSTRATE
- ✓ INSTANTLY INTERLOCK TO THE PRESERVED SUBSTRATE
- ✓ MAINTAIN STABILITY OVER TIME

SUBSTRATE PRESERVING TAP

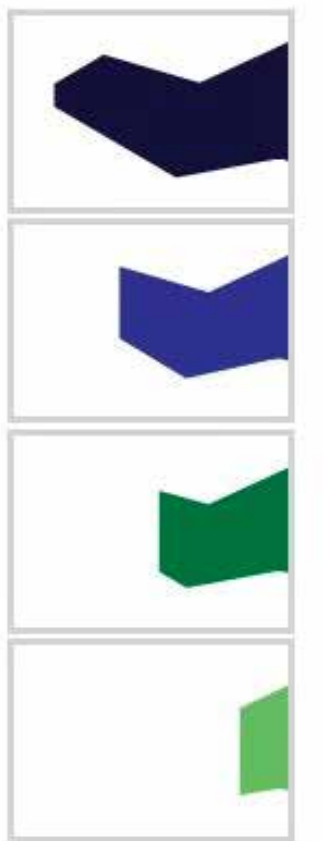
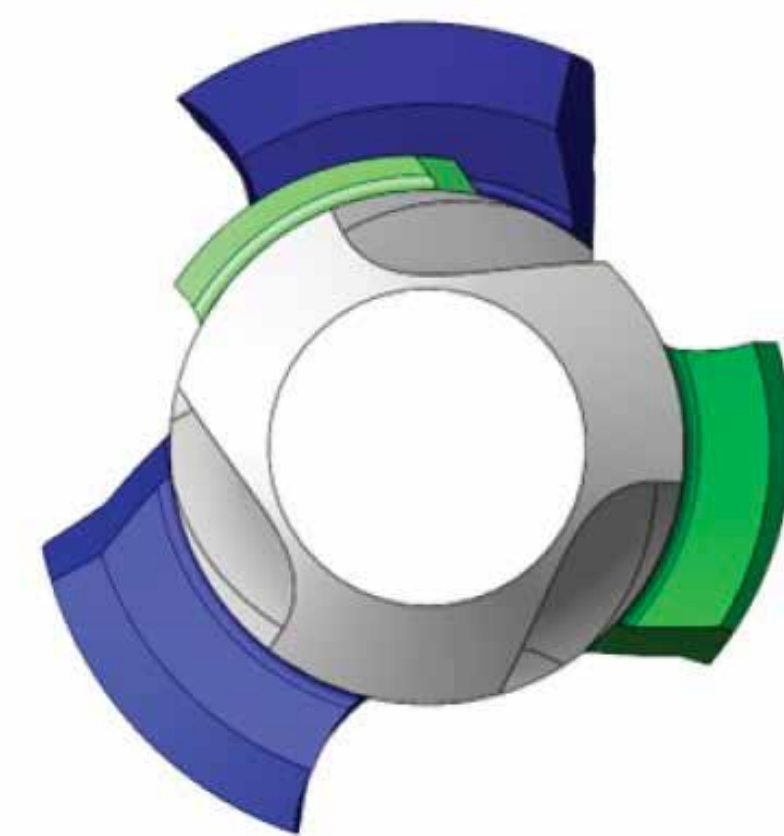

EXPERIENCE THE DIFFERENCE

CONVENTIONAL 'BUTTRESS' THREADS VS. UNIFIM.I. THREADS

INSERTION TEST



Conventional

- Crushes and plows during insertion
- Creates a damaged and unstable interface



UnifiM.I.

- Cleanly prepares and preserves during insertion
- Creates a stable and mechanically integrated interface

PULL TEST

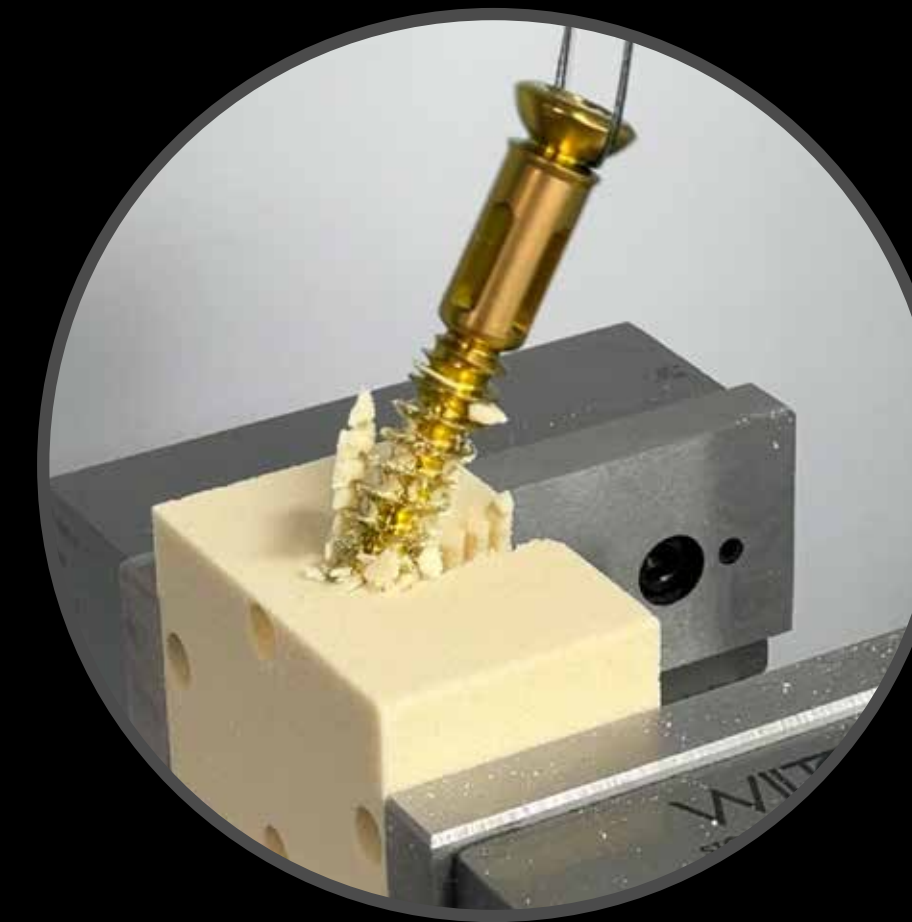

Conventional

- Non-integrated
- Interface crushed and fractured
- Limited load resistance on tension side



UnifiM.I.

- Integrated circumferentially
- Interface preserved and maintained
- Full load resistance on tension side via MI

UnifiM./ EXPLAINED

UNIQUE THREAD GEOMETRY: USING UNDERCUTS TO INTERLOCK WITH SUBSTRATE

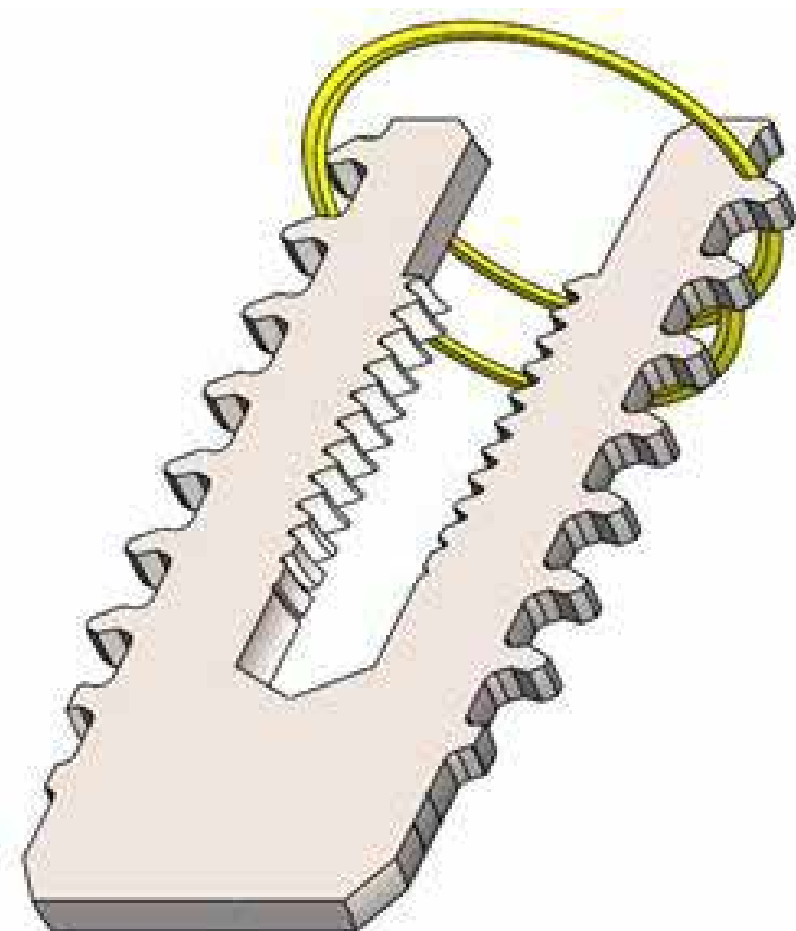

TRAILING UNDERCUT

Trailing undercut provides circumferential resistance to axial pull-out and toggle.

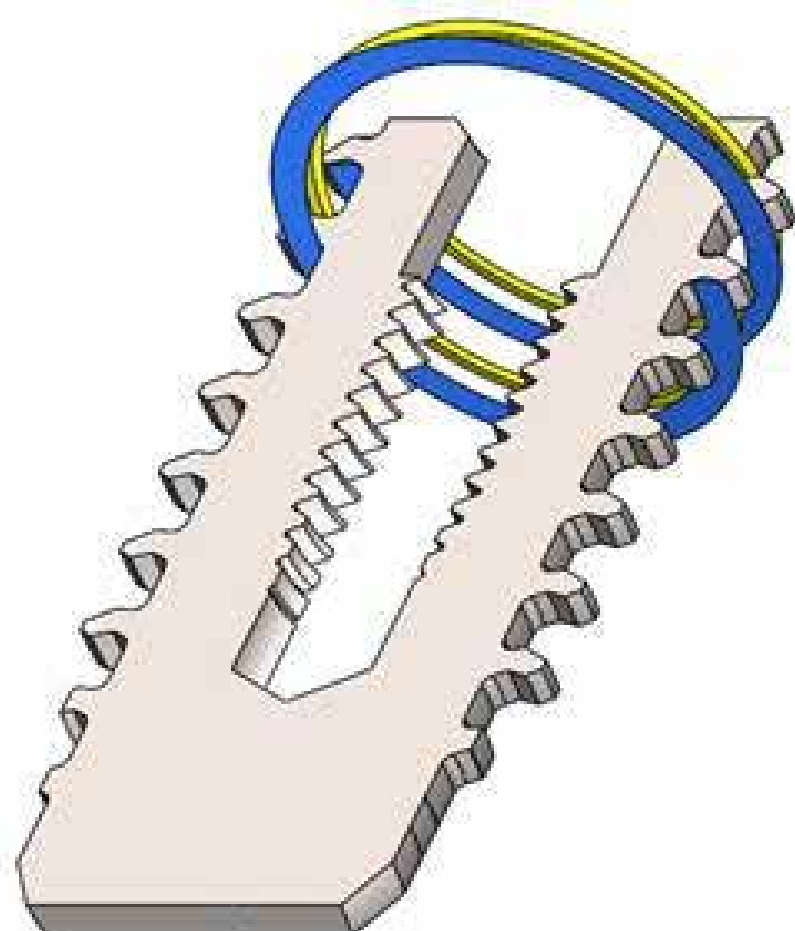

LEADING UNDERCUT

Leading undercut provides circumferential resistance to axial compression and toggle.

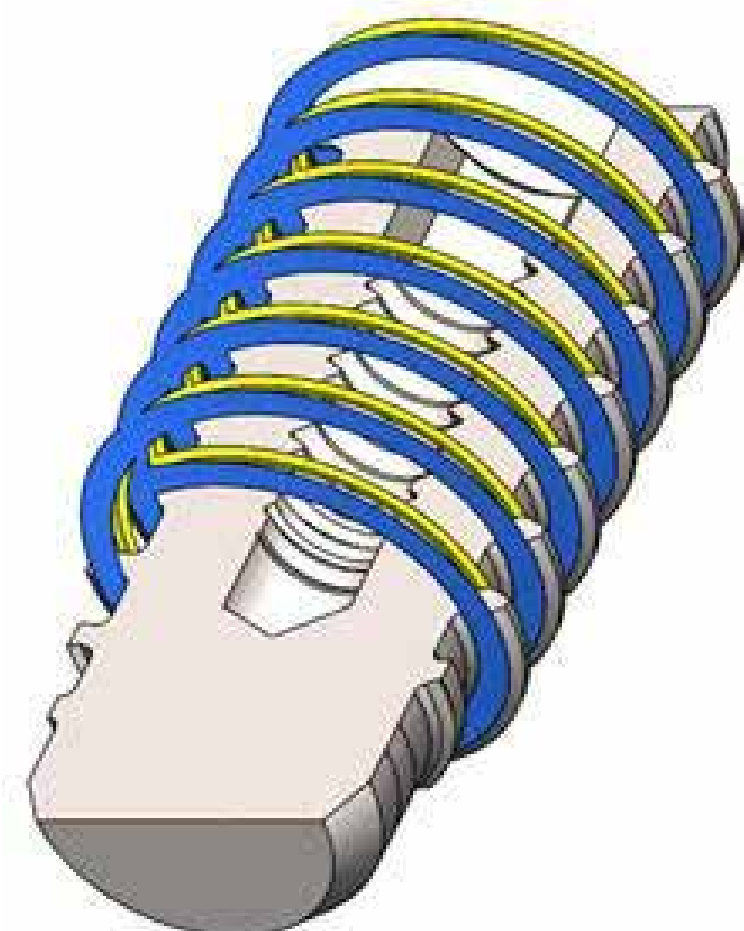

WORKING LENGTH

The unique undercut geometry resists loads and supports the insert within the substrate down the entire thread length.

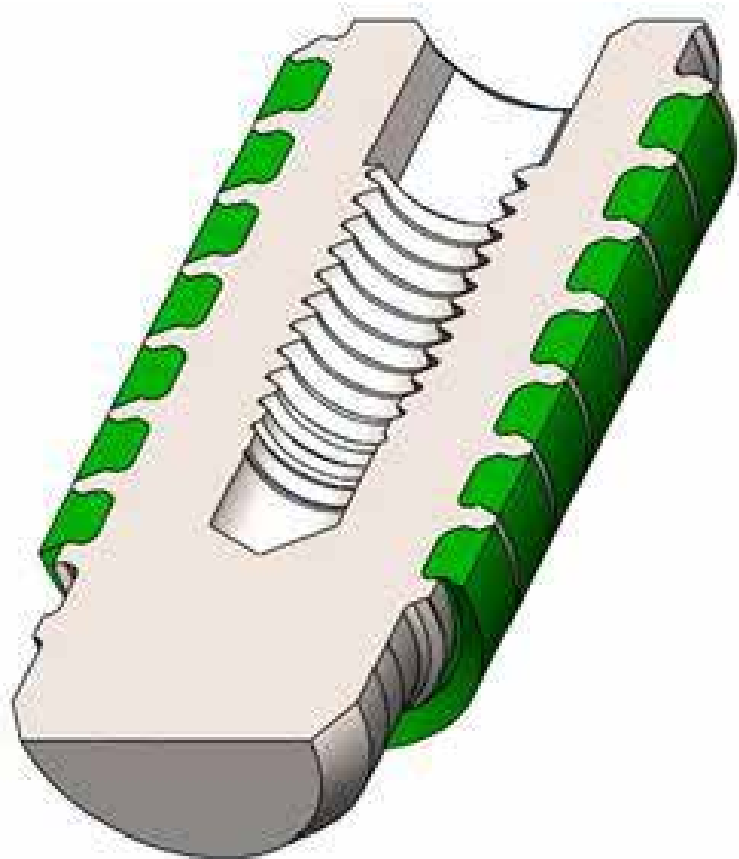

SUBSTRATE CAPTURE

The result is the interlocking of significant substrate volume between threads--providing immediate and lasting stability by sharing loads and reducing stress concentrations.



ADAPTABLE CHARACTERISTICS

BY SUBSTRATE APPLICATION

Ability to control interface depending upon:

- Material Demands
- Application Needs

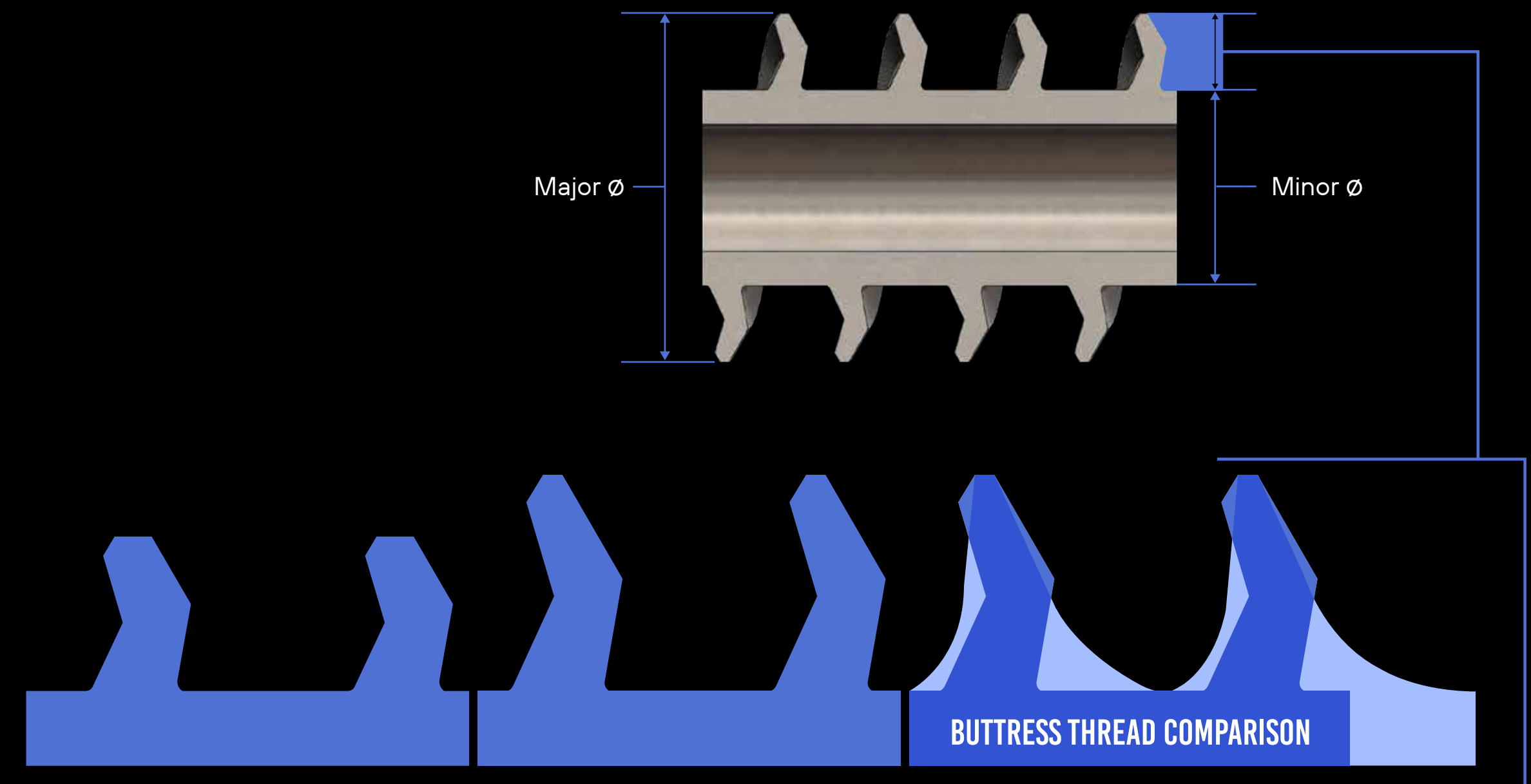

PERFORMANCE DRIVEN DESIGN



UNIFORM THREAD FORM

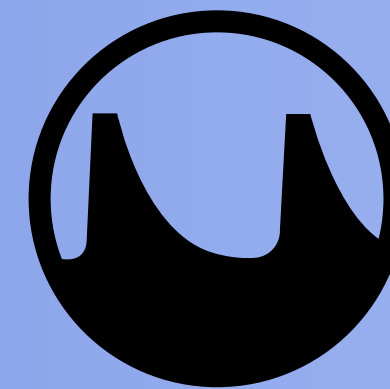

CONVENTIONAL 'BUTTRESS' THREAD FORM

DRILL OPTIMIZATION

TIP ANGLE

SPLIT POINT

PRIMARY & SECONDARY RELIEF

CORNER CHAMFER

FLUTE HELICAL ANGLE

FLUTE EDGE BREAK

FLUTE MARGIN

RESULTING IN

MORE ACCURATE HOLE SIZE

FASTER DRILLING SPEED

LOWER HEAT GENERATION

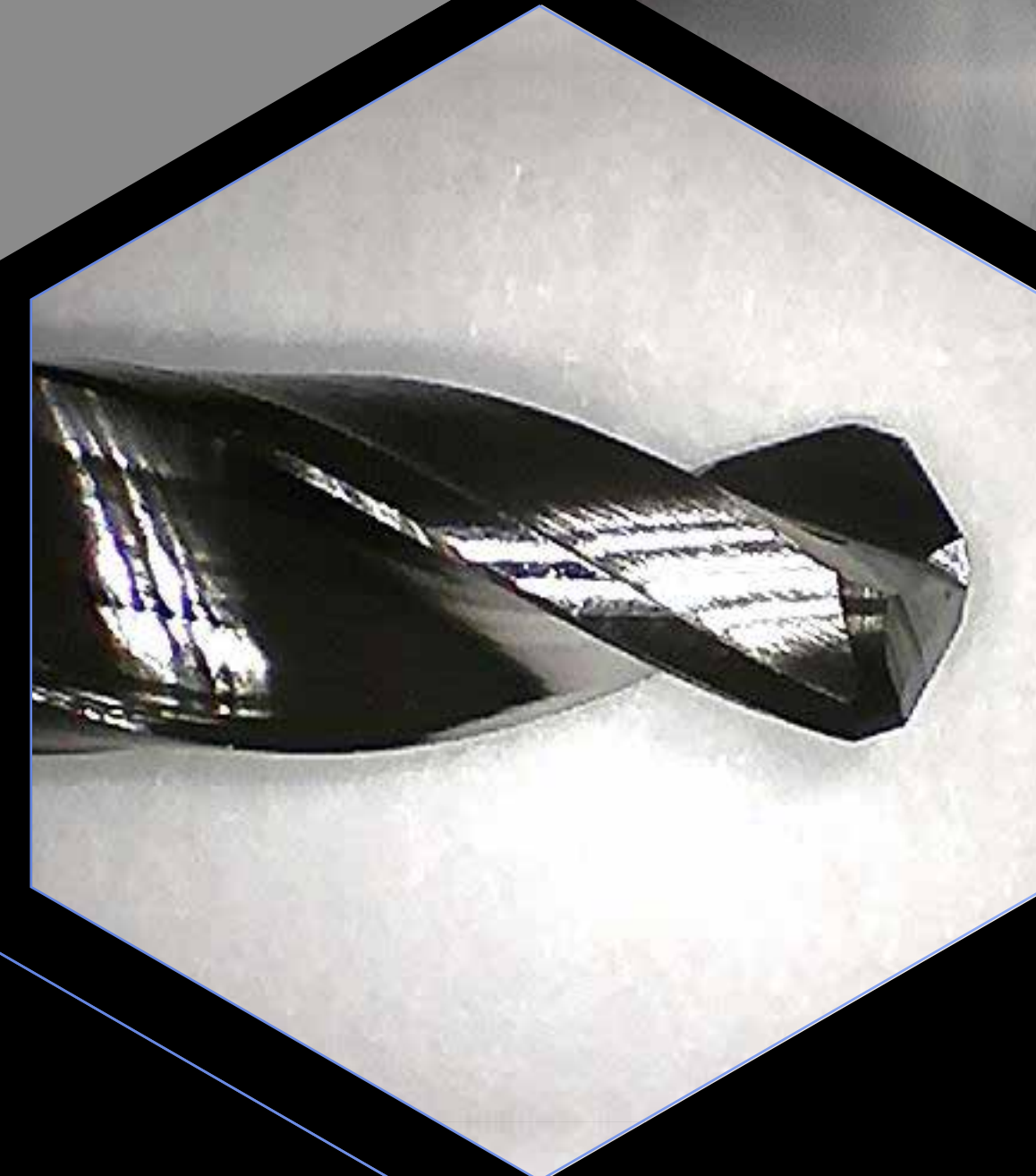
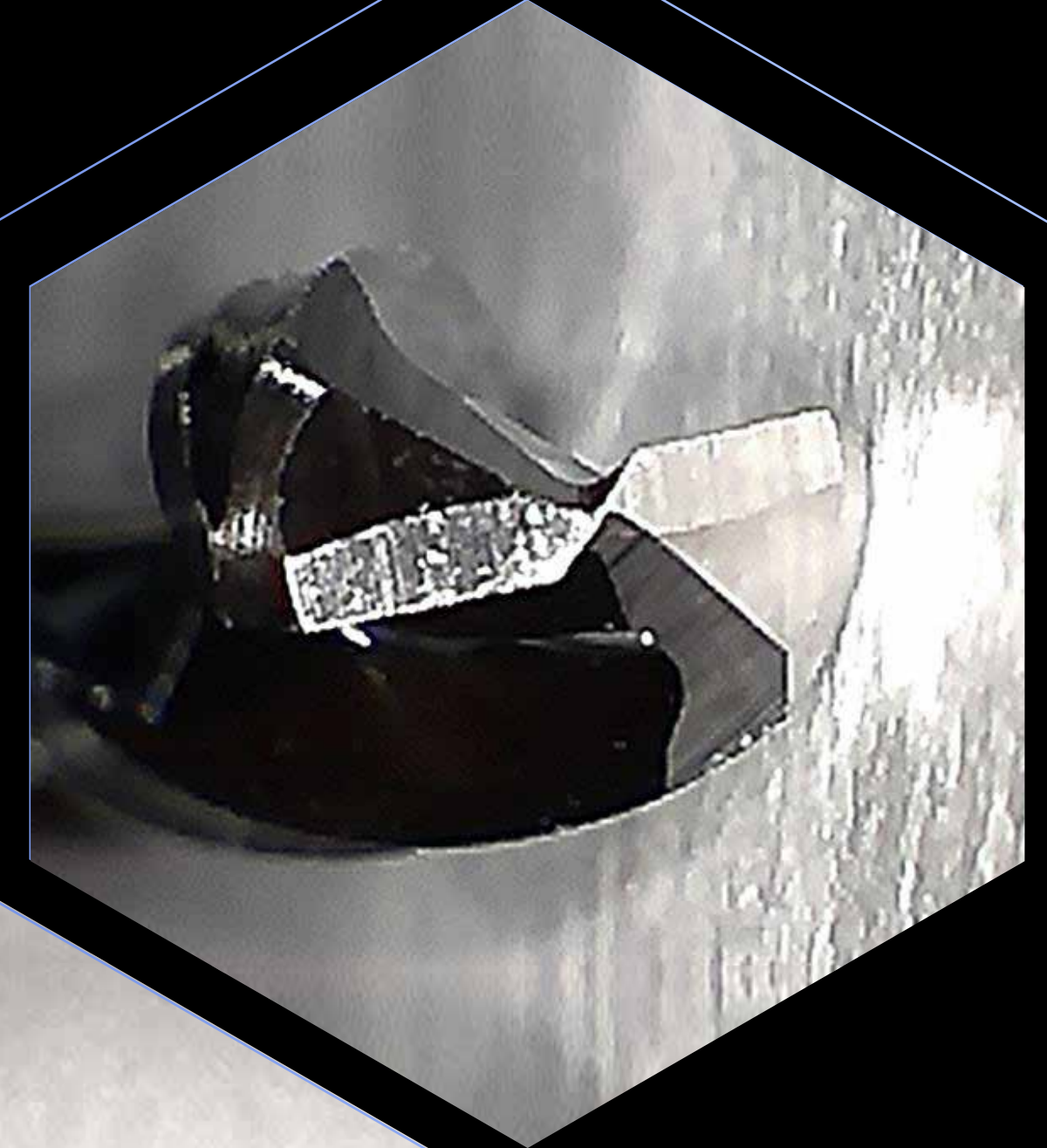
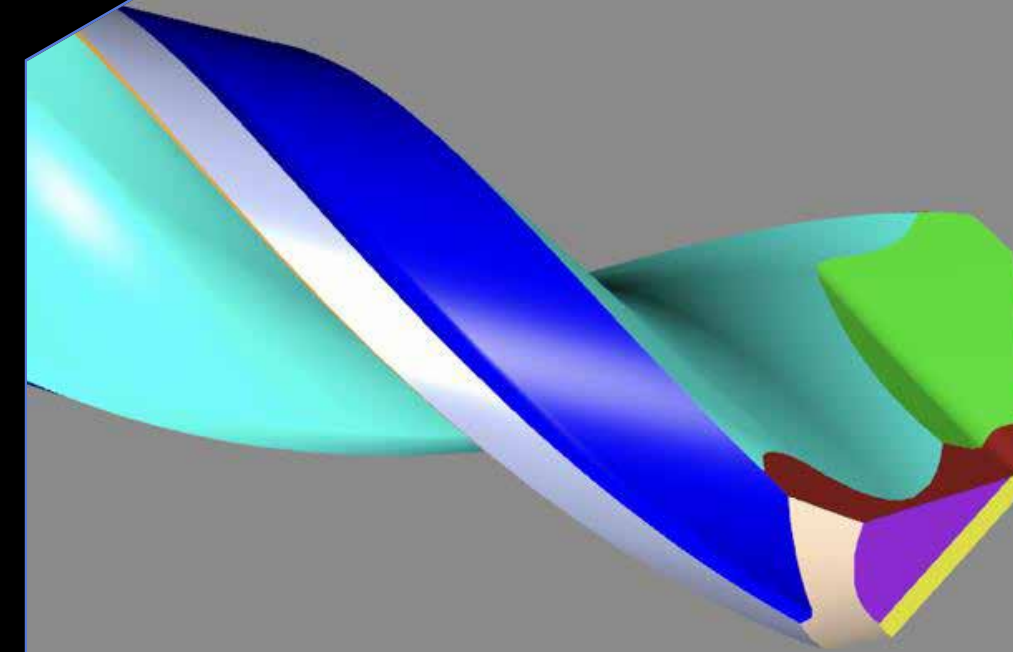

LEVERAGING KNOWLEDGE

APPLICATION OF INTELLECTUAL PROPERTY

DRILLING

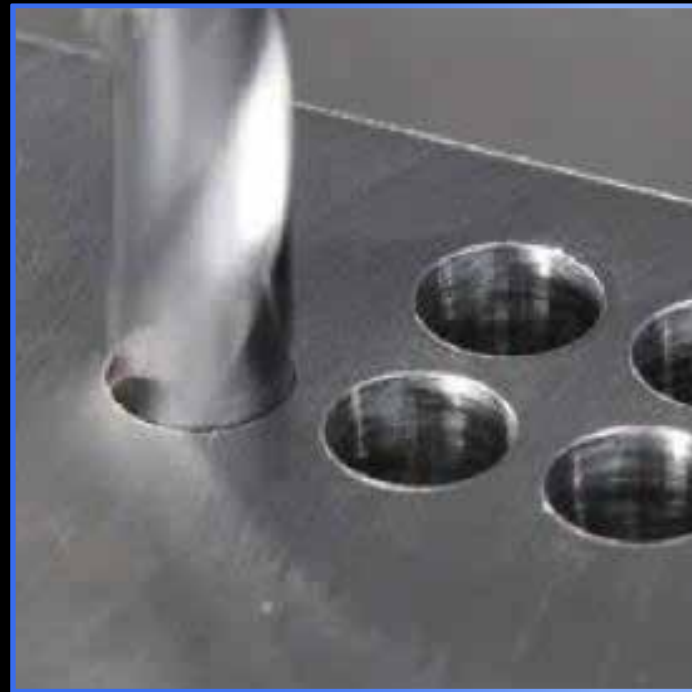

TAPPING

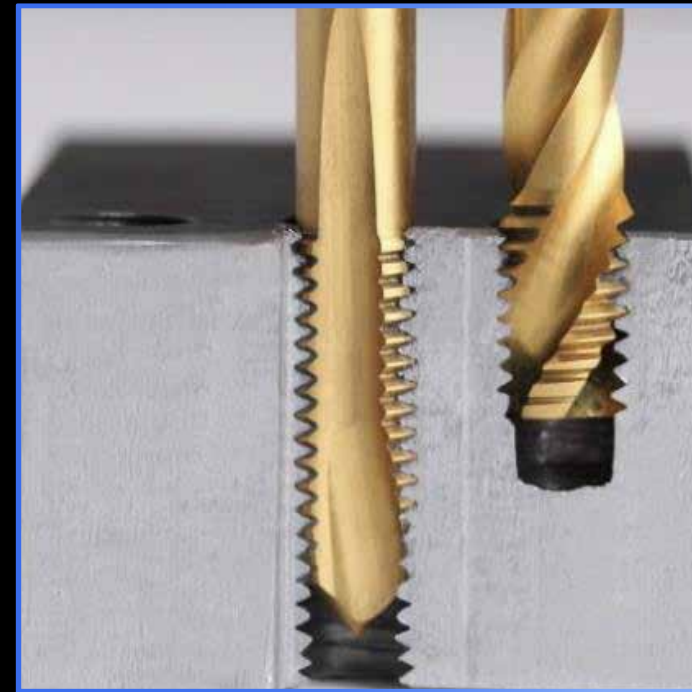

STRESS MANAGEMENT

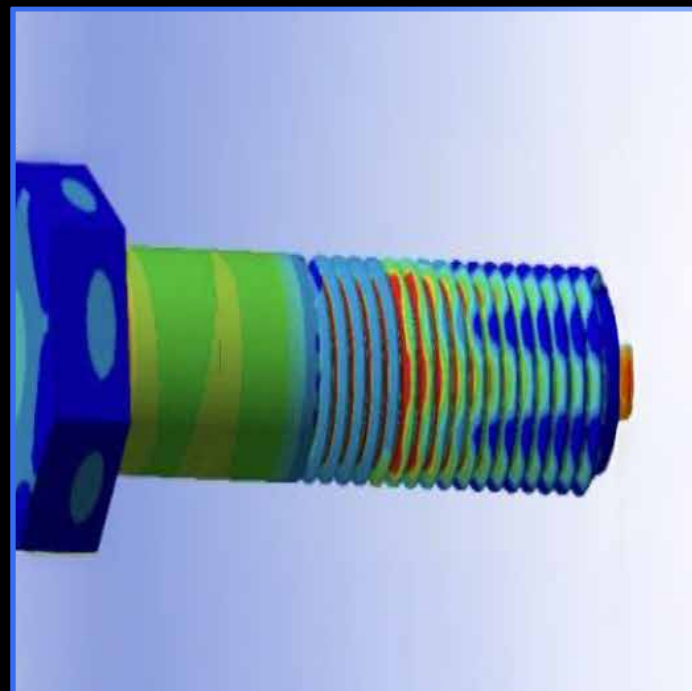

STABILITY

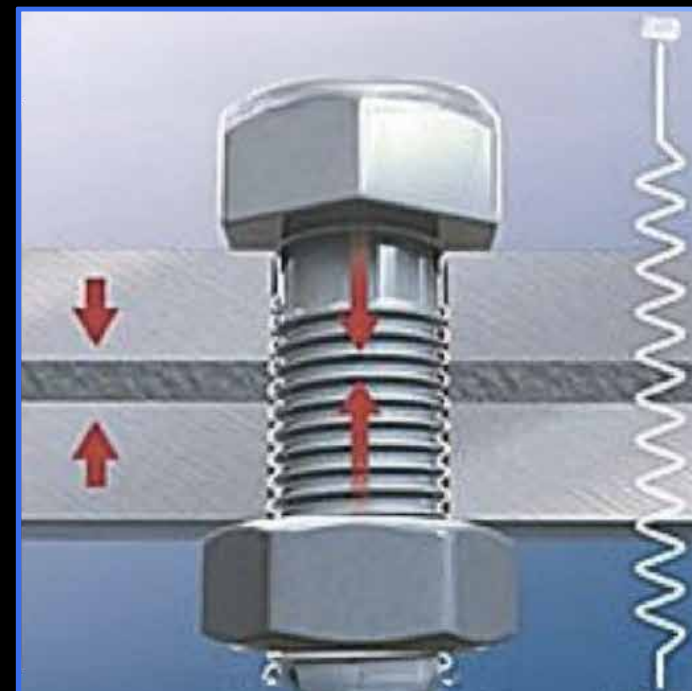

CONSTRUCTION APPLICATIONS

ADDRESSING KEY MARKET CHALLENGES



Unifi*M.I.* FASTENER PLATFORM

ENGINEERED TO DISSIPATE VIBRATIONAL
ENERGY & PROVIDE A LONG-TERM STABLE
CONNECTION

OPTIMAL MECHANICAL, STRUCTURAL &
FUNCTIONAL CONNECTION

REDUCE ASSEMBLY TIME, COST & WEIGHT

UTILIZE TRADITIONAL MANUFACTURING
TECHNIQUES



TARGET PARTNERS

\$492M
SALES



**WOOD
CONNECTION
PRODUCTS**

Wood Connectors,
Shearwalls,
connectors for
cold-formed steel
and structural
steel

**FASTENING
SYSTEMS**

Fasteners for
connectors,
structural screws,
decking screws,
and productivity
solutions

**CONCRETE
CONNECTION
PRODUCTS**

Mechanical and
adhesive anchors,
injection epoxies,
carbon fiber
strengthening
products

\$2B
SALES



STANLEY NELSON
Engineered Fastening

POP TUCKER **CRIBMASTER**



\$1.4B
SALES

TimberTech AZEK
EXTERIORS

Deck Fasteners & Stainless Steel Deck Screws



\$758M
SALES



**DRILL
SCREWS**



**STAINLESS
STEEL
SCREWS**



**SELF-
TAPPING
SCREWS**



\$1.2B
SALES

Trex

**COMPOSITE
PLUG
SCREWS**

In collaboration with Trex
Decking Depth Setters,
Trex Hideaway® Deck
Plugs and Trex Hideaway
Fascia Plugs, these screws
feature a tri-lobe design,
minimizing both effort and
any potential for
mushrooming.

**PHILLIPS
HEXSTIX®
DRIVE BIT**

Designed for precision,
this drive bit ensures a
stable, wobble-free
connection with every
use, making installations
with Trex components
straightforward and
reliable.

**COLOR
MATCH
SCREWS**

Designed to work
seamlessly with all Trex®
decking collections, dive
into driving without the fear
of mushrooming or color
stripping and let the beauty
of a Trex deck shine through
with Trex® Color-Match
Screws.





UnifiM.I. CONSTRUCTION ACTION PLAN

1. **Demonstrate** technology capabilities
 - a. Tool development of dies, taps and drills
 - b. Drilling and tapping of concrete, wood, and steel substrates
 - c. Fastener axial and off-axis load testing
2. Top down **education** with bottom up preparation
3. Execute **licensing** models
4. Bring **"killer app"** to market with partner
5. **Influence** design and specifications for next gen projects



UnifiM.I. CONSTRUCTION VALIDATION POINTS

STRUCTURAL & DYNAMIC
MECHANICAL TESTING

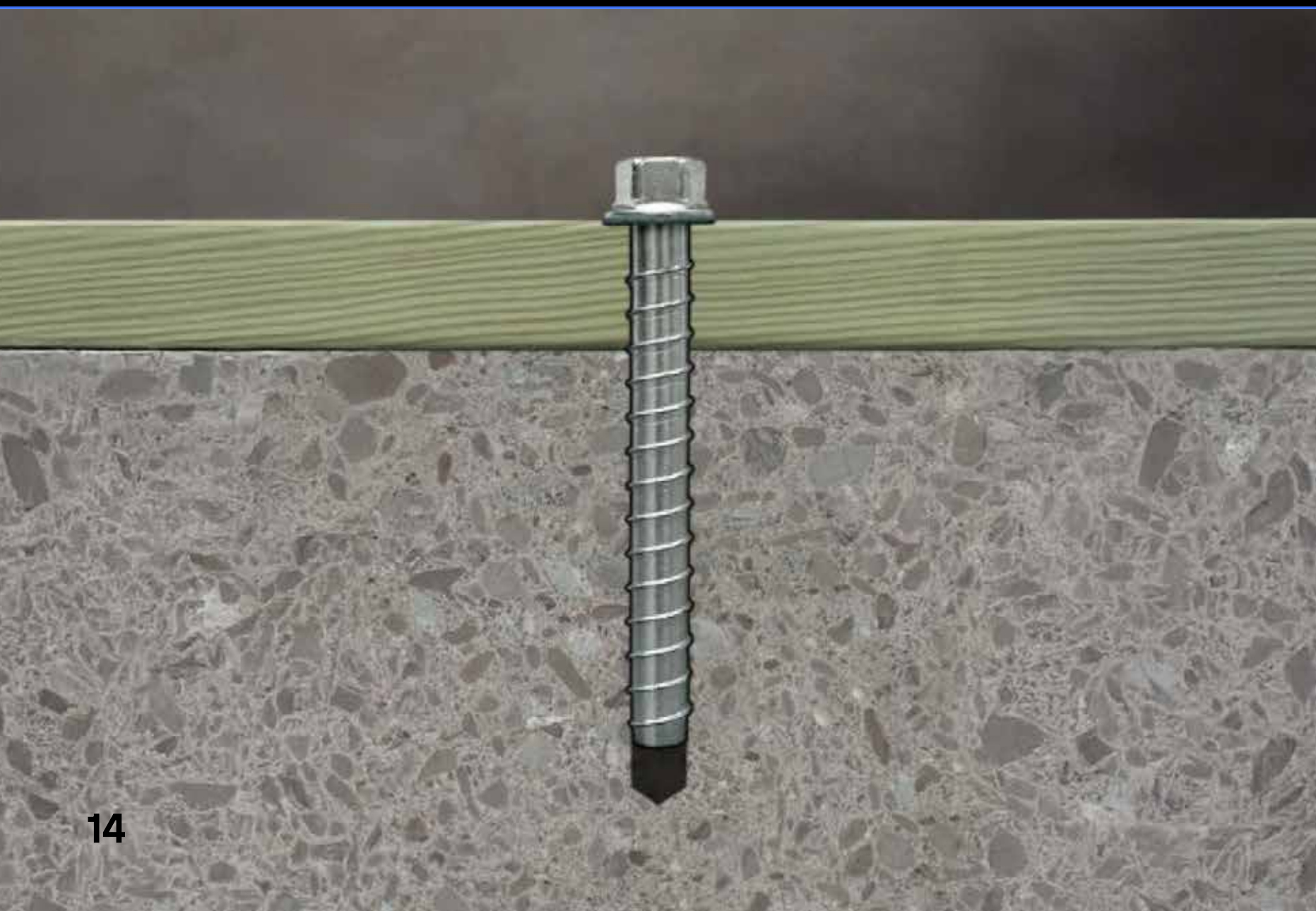



RESHAPING THE FUTURE



UnifiM.I.[™]
CONSTRUCTION, LLC